

3 D

Perfect to live Wall

DECORATIVE 3D WALL PANEL



General Performance Data



Flammability
UI94 / V-0
(Optional)



Surface Quality
A1



Flexural Strength
ISO17B / 63Mpa



Size Accuracy
 $\pm 0.05\%$



Temperature
Resistance
 $-40/+82\text{ }^{\circ}\text{C}$



Thickness
Accuracy
 $\pm 0.005\%$

DUREX
SERIES



DUREX
SERIES



DUREX
SERIES

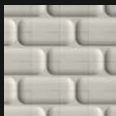
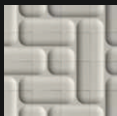
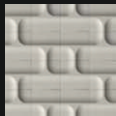

PRODUCT INTRODUCTION GUIDE/DUREX

The model of The 2nd generation Durex

A new model where you can create 6-7 different wall designs with a single tile design.

There will be 2 different part : 1 - bottom installation part : 2-upper visual part

The upper visual part will be installed after the bottom part.

The sub-frame port has screwing and centering holes. It can be

centered to each other easily. The installation method is same as LEGO system.



Black



White



Silver



Mink



Gold



Smoke

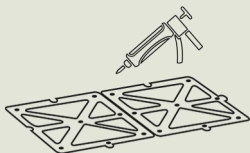
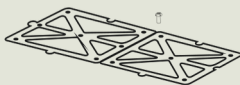
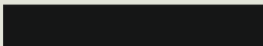

- 1** | Start the pasting process by applying silicone behind the bottom apparatus

- 2** | Once the pasting process is over, strengthen the apparatus by screwing it from determined points.

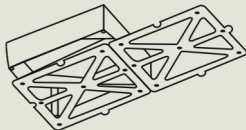
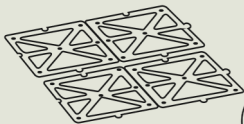

- 3** | The centralization details that are on the installation apparatus and bottom apparatus are each other, attached to

- 4** | Complete the installation process by attaching the pin space holes that are on the inside of the top parts of the product to the pin bulges that are on the bottom installation apparatus.



OWEL
S E R I E S





ALL COLOUR AVAILABLE

OWEL
S E R I E S



White



Gold



Black



Mink



Silver



Smoke

● **PRODUCT INTRODUCTION GUIDE / OWEL**

Owel is the newest and latest wall design panel of the world

Owel model has model modular lines which bring impact to spaces with pattern, texture and color.

There will be 2 different part: 1- bottom installation part 2 - upper visual part

The upper visual part will be installed after the bottom part.

The sub-frame part has screwing and centering holes.

It can be centered to each other easily. The installation method is same as LEGO system.



OWEL
S E R I E S

PRODUCT INTRODUCTION GUIDE / OWEL

Owel is the newest and latest wall design panel of the world

Owel model has model modular lines which bring impact to spaces with pattern, texture and color.

There will be 2 different part: 1- bottom installation part 2 - upper visual part

The upper visual part will be installed after the bottom part.

The sub-frame part has screwing and centering holes.

It can be centered to each other easily. The installation method is same as LEGO system.



Black



White



Silver



Mink



Gold



Smoke

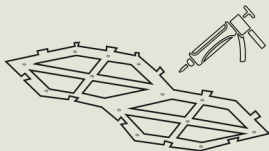
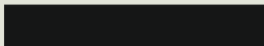

- 1** | Start the pasting process by applying silicone behind the bottom apparatus

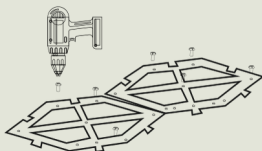

- 2** | Once the pasting process is over, strengthen the apparatus by screwing it from determined points.

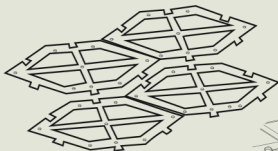

- 3** | The centralization details that are on the installation apparatus and bottom apparatus are each other, attached to



- 4** | Complete the installation process by attaching the pin space holes that are on the inside of the top parts of the product to the pin bulges that are on the bottom installation apparatus.

ALL COLOUR AVAILABLE



Black



White



Silver



Mink



Smoke



Gold

CRYSTAL
S E R I E S





CRYSTAL
S E R I E S



CRYSTAL
S E R I E S

1

CONTENTS

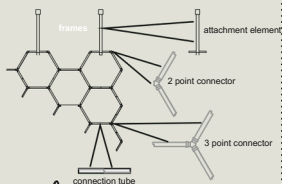

facets

**Please install this product
with two or more people**

For information or questions visit:

2

CEILING ATTACHMENT

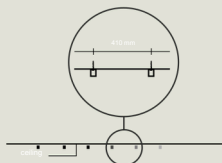

Attach the **ceiling attachment upper parts** in one straight line against the ceiling with a distance of 410 mm. **The first ceiling attachment upper part starts 205mm** from left or right side of the screen. Use the right fastening materials for the right ceiling*.

3

CONNECTING THE FRAMES

- 1 - Connector consists of two parts
- 2- Connect the frames vertical together with the connection tubes

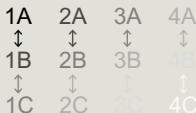

- 3 - Connect the frames horizontal together with the connection tubes



The amount of frame parts depend on the size of your divider.

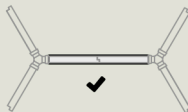
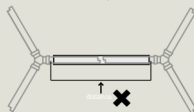

4

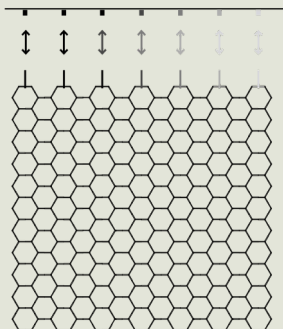

PLACING THE FRAME

Place the frame in the ceiling attachment upper parts and secure with an imbus key. Be careful, very fragile. Do this step with enough people to hold it steady!

Make sure that if the screw is left on the outside, it means that the screw is not properly aligned in the picture. If it disappears completely, then it is properly aligned.*



5

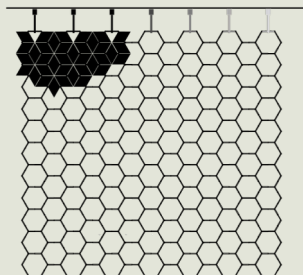

PLACING THE FACETS

1 - Fill the frame with the facets. Start at the top and work your way down to the bottom.

2 - Your Facet divider is ready!



Make sure that the facets are closed over the whole side, all 12 lockpoints, otherwise the frame will not be secured and may fall apart. If a facet doesn't close properly this is occurred because a frame connection isn't closed properly.*

Do The Fitting By Placing The A A₂ Pieces Written Below Face To Face



SPARKL
S E R I E S

SPARKL

S E R I E S

Black

Silver

Mink

ALL COLOUR AVAILABLE

White

Smoke

Gold

SPARKL
S E R I E S



PRODUCT INTRODUCTION GUIDE / SPARKL

Sparkl is the newest and Latest wall design panel of the World model modular lines which bring impact to spaces with pattern, texture and color.

There will be 2 different part: 1-bottom installation part 2 - upper visual part

The upper visual part will be installed after the bottom part.

The sub-frame part has screwing and centering holes. It can be centered to each other easily. The installation method is same as LEGO system.



Black



White



Silver



Mink



Gold



Smoke

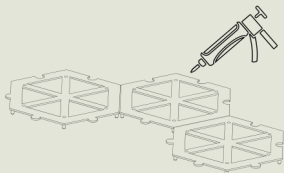
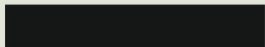

- 1** Start the pasting process by applying silicone behind the bottom apparatus



- 3** The centralization details that are on the installation apparatus and bottom apparatus are each other, attached to

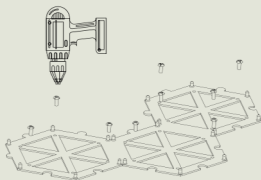

- 2** Once the pasting process is over, strengthen the apparatus by screwing it from determined points.

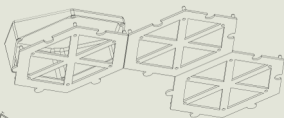

- 4** Complete the installation process by attaching the pin space holes that are on the inside of the top parts of the product to the pin bulges that are on the bottom installation apparatus.

ROLLS
S E R I E S



ROLLS SERIES



Black



White



Silver



Mink



Smoke



Gold

ALL COLOUR AVAILABLE





ROLLS
S E R I E S

PRODUCT INTRODUCTION GUIDE / ROLLS

Rolls was designed as a modular wall design panel

Rolls model has modular lines which bring impact to spaces with pattern, texture and color.

There will be 2 different part: 1-bottom installation part 2-upper visual part

The upper visual part will be installed after the bottom part.

The sub-frame part has screwing and centering holes.

It can centered to each other easily. The installation method is same as LEGO system.



Black



White



Silver



Mink



Gold



Smoke

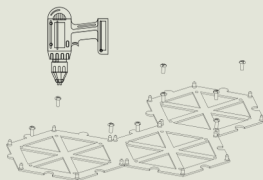
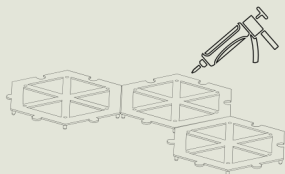
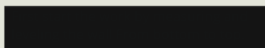

- 1** | Start the pasting process by applying silicone behind the bottom apparatus

- 2** | Once the pasting process is over, strengthen the apparatus by screwing it from determined points.

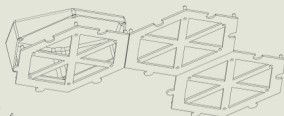

- 3** | The centralization details that are on the installation apparatus and bottom apparatus are each other, attached to



- 4** | Complete the installation process by attaching the pin space holes that are on the inside of the top parts of the product to the pin bulges that are on the bottom installation apparatus.



LEXUS-D1 SERIES



Black



White



Silver



Mink



Smoke



Gold

ALL COLOUR AVAILABLE





LEXUS-D2 SERIES



Black



White



Silver



Mink



Smoke



Gold

ALL COLOUR AVAILABLE

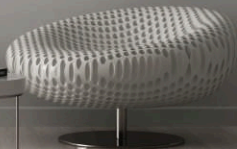
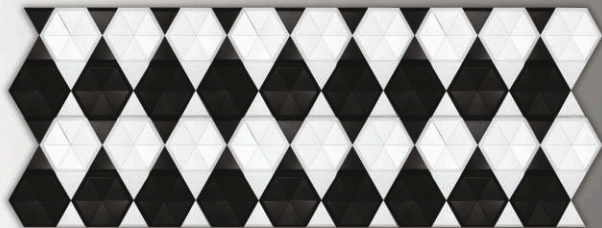

ALL COLOUR AVAILABLE

LEXUS-D3
SERIES



Black



White



Mink



Silver



Smoke



Gold





LEXUS D3
S E R I E S



LEXUS D3
S E R I E S

ALL COLOUR AVAILABLE

LEXUS-D4
SERIES



Black



White



Silver



Mink



Gold



Smoke



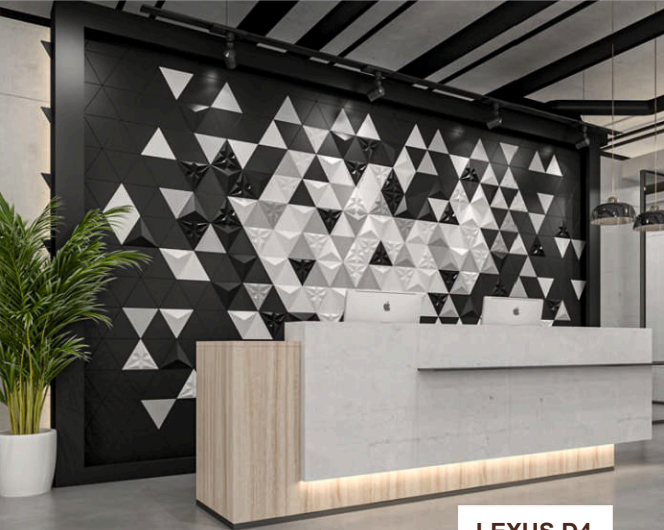

LEXUS D4
S E R I E S



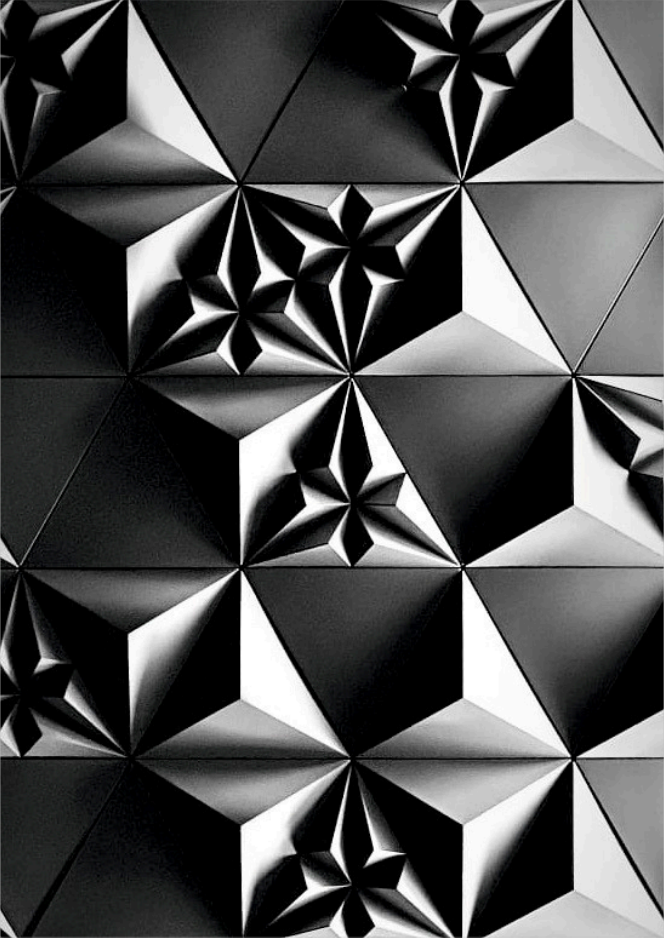

PRODUCT INTRODUCTION GUIDE/LEXUS

The first model of 2nd generation This model is formed by combining 3 different tiles. You can create many different patterns by using flat, pyramid and polygon tiles together or separately.

There will be 2 different part: 1 - bottom installation part 2 - upper visual part

The upper visual part will be installed after the bottom part.

The sub-frame part has screwing and centering holes. It can be centered to each other easily. The installation method is same as LEGO system.

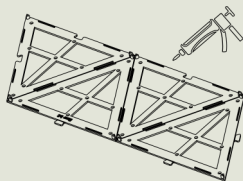

1 Start the pasting process by applying silicone behind the bottom apparatus

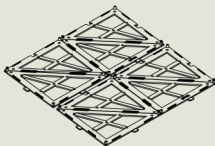

3 The centralization details that are on the installation apparatus and bottom apparatus are each other, attached to

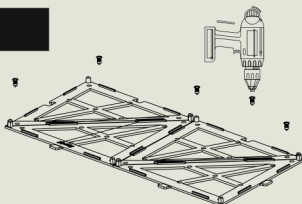

2 Once the pasting process is over, strengthen the apparatus by screwing it from determined points.

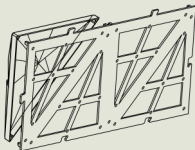

4 Complete the installation process by attaching the pin space holes that are on the inside of the top parts of the product to the pin bulges that are on the bottom installation apparatus.

WOODEN
SERIES

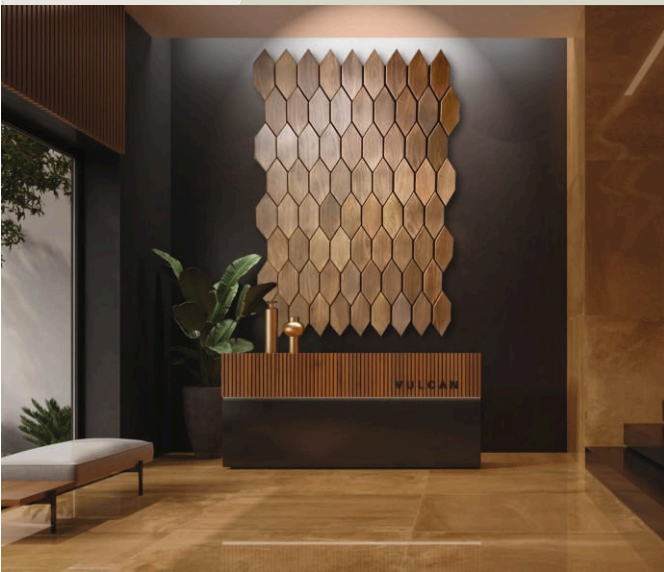
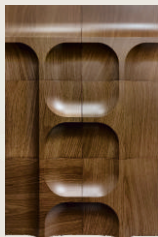



PRINTED MARBLE
SERIES

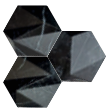



PRINTED MARBLE S E R I E S



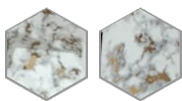

PRINTED GOLD
S E R I E S

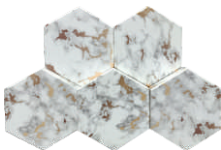

3 D